

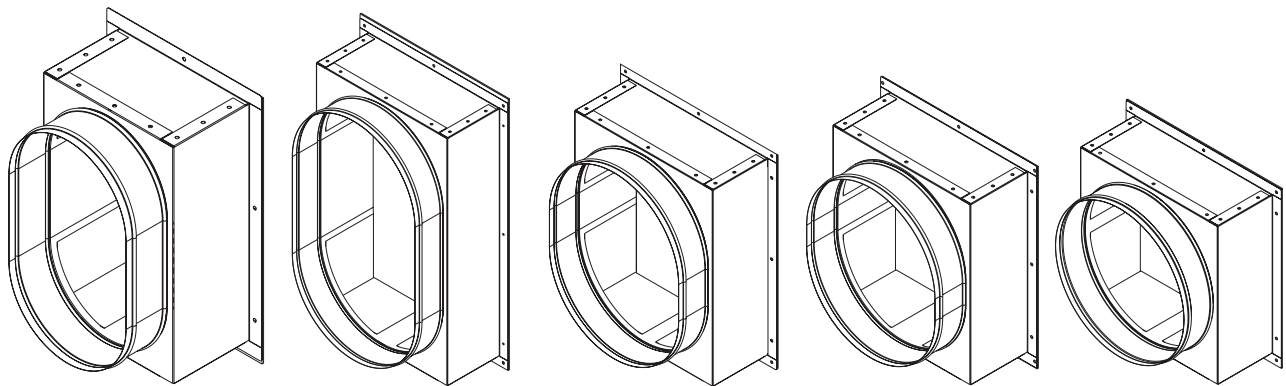

INSTALLATION INSTRUCTIONS

Square to Round Adapter Kit



BX-SVN-JAYSQRD-1B-EN



RECOGNIZE THIS SYMBOL AS AN INDICATION OF IMPORTANT SAFETY INFORMATION



WARNING

These instructions are intended as an aid to qualified licensed service personnel for proper installation, adjustment and operation of this unit. Read these instructions thoroughly before attempting installation or operation. Failure to follow these instructions may result in improper installation, adjustment, service or maintenance possibly resulting in fire, electrical shock, property damage, personal injury or death.



DO NOT DESTROY THIS MANUAL

Please read carefully and keep in a safe place for future reference by a serviceman.

Safety Section

⚠ WARNING

HAZARDOUS VOLTAGE!

Failure to follow this Warning could result in property damage, severe personal injury, or death. Disconnect all electric power, including remote disconnects before servicing. Follow proper lockout/tagout procedures to ensure the power cannot be inadvertently energized.

⚠ CAUTION

SHARP EDGE HAZARD!

Failure to follow this Caution could result in personal injury. Be careful of sharp edges on equipment or any cuts made on sheet metal while installing or servicing. Personal injury may result.

General Data

The purpose of the adapter kit is to provide easy conversion from square opening supply and return using the standard round ducts.

Kit Contents

Items	Quantity
Supply Adapter	1
Return Adapter	1
Gasket	A/R

Inspection

Check carefully for any shipping damage. This must be reported to and claims made against the transportation company immediately. Any missing parts should be reported to your supplier at once and replaced with authorized parts only.

Kit Identification

Confirm that the supply and return duct adapter kits are correct for your unit. Refer to the Table 1 to verify proper adapter kits and product model number.

Table 1. Adapter Kits Matching Units

Unit Type	Models	Adapter Kits	
		Supply	Return
Gas/Electric Unit	24 - 60	JAYSQRD001	JAYSQRD001
Heat Pump Unit	24 - 36	JAYSQRD001	JAYSQRD004
	42 - 60	JAYSQRD001	JAYSQRD005
Double Deck Gas Units	24 - 42	JAYSQRD002	JAYSQRD002
	48 - 60	JAYSQRD003	JAYSQRD003

Installation Instructions

Install Adapter Kits to Gas–Electric Units

1. Remove the panels covering both the horizontal supply and return openings on the unit.
2. Attach gasket to the flanges on both the adapters.
3. Place one adapter over the supply opening on the cabinet. Align the adapter so that the approximate position of the adapter is 2.27" from the side of the cabinet and 1.27" from the bottom of the cabinet. Secure with sheet metal screws. See Figures 1 and 2.

Figure 1. Install Supply Adapter

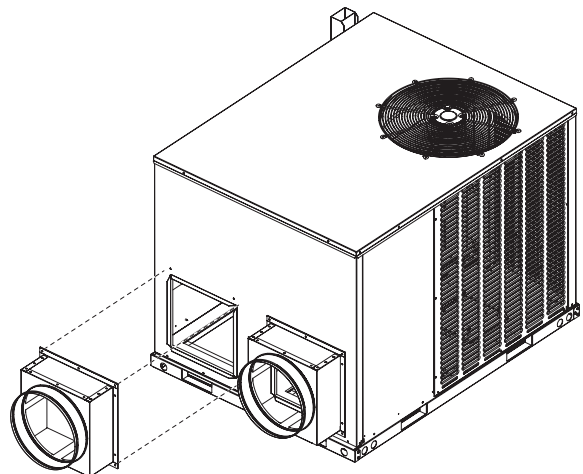

4. Place another adapter over the return opening on the cabinet. Align the adapter so that the approximate position of the adapter is 5.71" from the right side flange of the supply adapter and 1.27" from the bottom of the cabinet. Secure with sheet metal screws. See Figure 2.

Figure 2. Install and Align Return Adapter

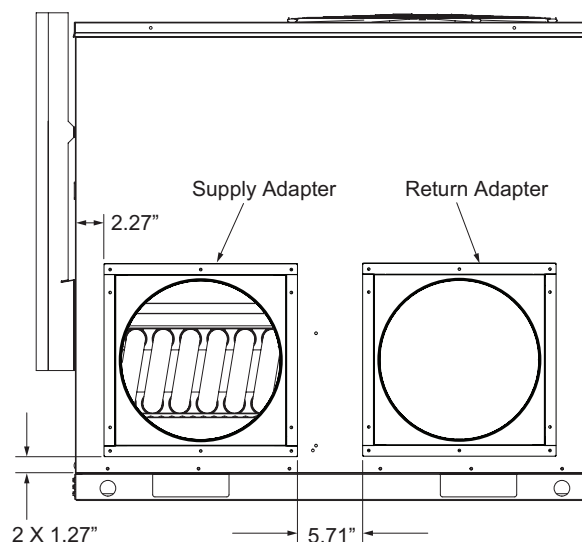

Install Adapter Kits to Heat Pump Units

1. Do the Steps 1 and 2 as instructed in the procedure "Install Adapter Kits to Gas-Electric Units".

2. **For *****24 – 36 Heat Pump Units –**

- a) Place one adapter over the supply opening on the cabinet. Align the adapter so that the left side flange of the adapter is flush with the side of the cabinet and the bottom flange of the adapter is approximately 0.66" from the bottom of the cabinet. Secure with sheet metal screws. See Figures 3 and 4.

- b) Place another adapter over the return opening on the cabinet. Align the adapter so that the approximate position of the adapter is 1.92" from right side flange of the supply adapter and 0.66" from the bottom of the cabinet. Secure with sheet metal screws. See Figure 4.

NOTE: Notice orientation of the return adapter. The shorter side of the return adapter is either at the top or bottom.

**Figure 3. Install Supply Adapter
(*****24 – 60 models)**

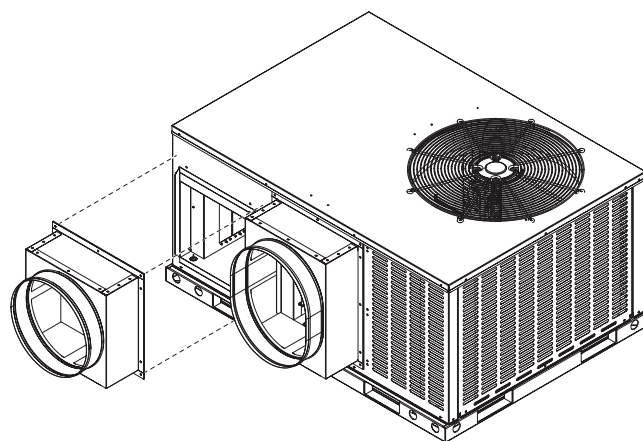

**Figure 4. Install and Align Return Adapter
(*****24 – 36 models)**

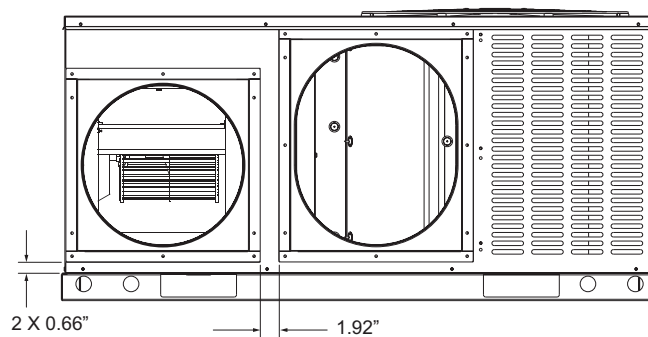

3. For *****42 – 60 Heat Pump Units –

- a) Place one adapter over the supply opening on the cabinet. Align the adapter so that the approximate position of the adapter is 0.72" from the side of the cabinet and 0.66" from the bottom of the cabinet. Secure with sheet metal screws. See Figures 3 and 5.
- b) Place another adapter over the return opening on the cabinet. Align the adapter so that the approximate position of the adapter is 3.85" from the right side flange of the supply adapter and 0.66" from the bottom of the cabinet. Secure with sheet metal screws. See Figure 5.

NOTE: Notice orientation of the return adapter. The shorter side of the return adapter is either at the top or bottom.

Figure 5. Install and Align Return Adapter (***42 – 60 models)**

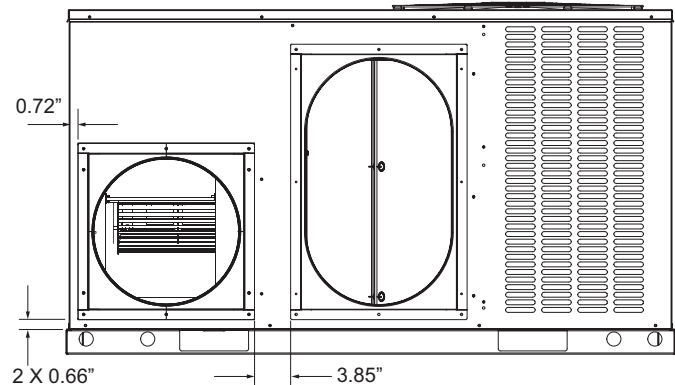

Horizontal Installation of Adapter Kits to Double Deck Gas Units

1. Do the Steps 1 and 2 as instructed in the procedure "Install Adapter Kits to Gas-Electric Units".

2. For *****24 – 42 Double Deck Gas Units –

- a) Place one adapter over the supply opening on the cabinet. Align the adapter so that the approximate position of the adapter is 3.09" from the side of the cabinet and 4.14" from the bottom of the cabinet. Secure with sheet metal screws. See Figures 6 and 7.

- b) Place another adapter over the return opening on the cabinet. Align the adapter so that the approximate position of the adapter is 19.00" from the right side flange of the supply adapter and 4.14" from the bottom of the cabinet. Secure with sheet metal screws. See Figure 7.

NOTE: Notice orientation of both the supply and return adapters. The shorter side of both the adapters are either at the top or bottom.

Figure 6. Install Supply Adapter (***24 – 42 models)**

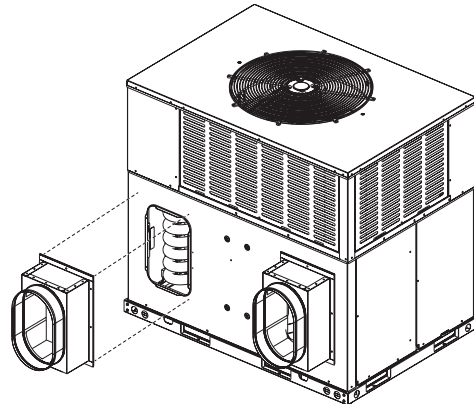
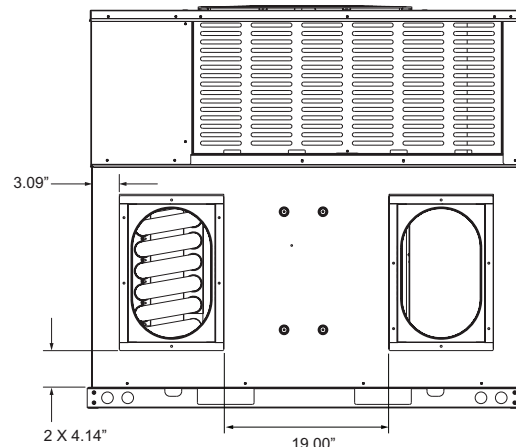

Figure 7. Install and Align Return Adapter (***24 – 42 models)**



3. For *****48 – 60 Double Deck Gas Units –

- a) Place one adapter over the supply opening on the cabinet. Align the adapter so that the approximate position of the adapter is 3.37" from the side of the cabinet and 3.05" from the bottom of the cabinet. Secure with sheet metal screws. See Figures 8 and 9.

- b) Place another adapter over the return opening on the cabinet. Align the adapter so that the approximate position of the adapter is 10.79" from the right side flange of the supply adapter and 3.05" from the bottom of the cabinet. Secure with sheet metal screws. See Figure 9.

NOTE: Notice orientation of both the supply and return adapters. The shorter side of both the adapters are either at the top or bottom.

Figure 8. Install Supply Adapter
(*****48 – 60 models)

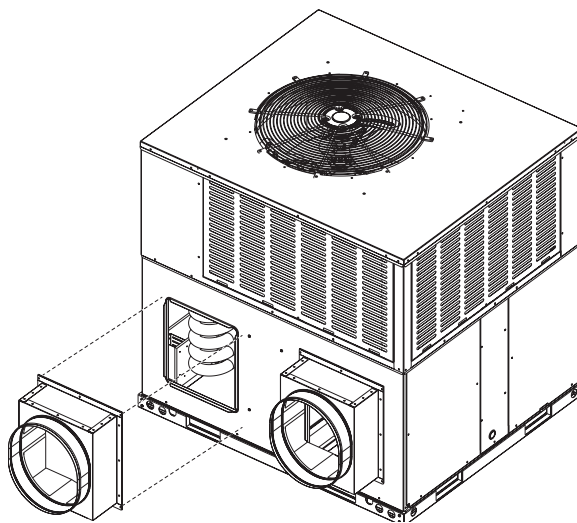
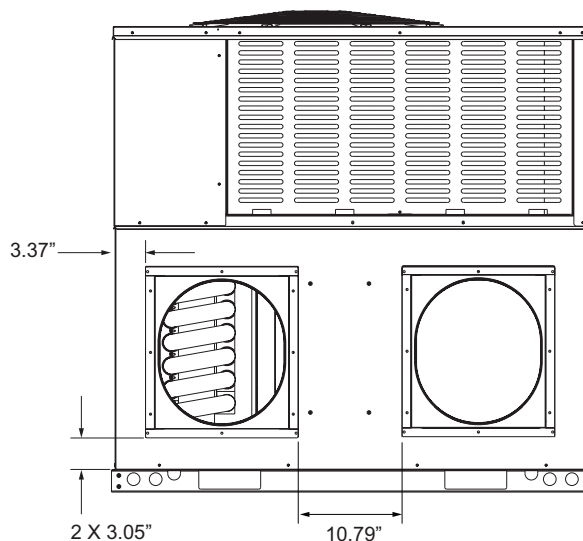

Figure 9. Install and Align Return Adapter
(*****48 – 60 models)



Downflow Installation of Adapter Kits to Double Deck Gas Units

1. Do the Steps 1 and 2 as instructed in the procedure "Install Adapter Kits to Gas-Electric Units".

2. **For *****24 – 42 Double Deck Gas Units –**

- Place the return adapter at the top of roof curb. Align the adapter inside the roof curb opening. Secure return adapter with sheet metal screws on roof curb. See Figures 10 and Figure 11.
- Place supply adapter over the top of other roof curb opening and repeat the step a). See Figure 11 for alignment dimensions.
- Remove Block plate from the bottom of the unit (if attached). See Figure 10, View A.
- Place the unit above the roof curb and align properly.

NOTE: Notice orientation of both the supply and return adapters. The shorter side of both the adapters are either at the top or bottom.

**Figure 10. Install Supply Adapter
(*****24 – 42 models)**

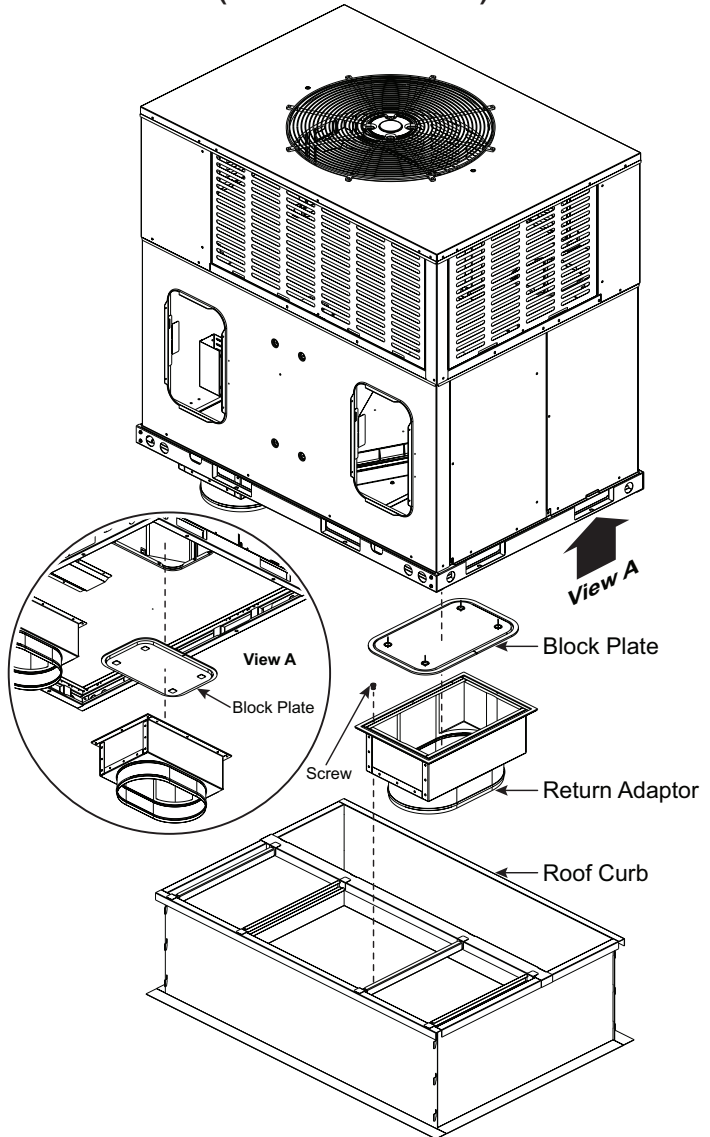

**Figure 11. Install and Align Supply Adapter
(*****24 – 42 models)**

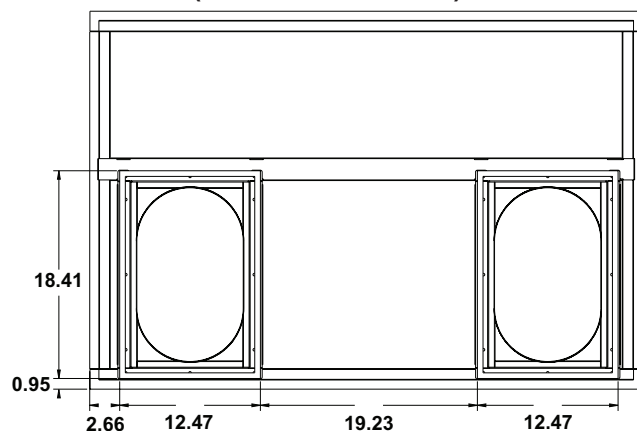

3. For *****48 – 60 Double Deck Gas Units –

- a) Place the return adapter at the top of roof curb. Align the adapter inside the roof curb opening. Secure return adapter with sheet metal screws on roof curb. See Figures 12 and Figure 13.
- b) Place supply adapter over the top of other roof curb opening and repeat the step a). See Figure 13 for alignment dimensions.
- c) Remove Block plate from the bottom of the unit (if attached). See Figure 12, View A.
- d) Place the unit above the roof curb and align properly.

NOTE: Notice orientation of both the supply and return adapters. The shorter side of both the adapters are either at the top or bottom.

Figure 12. Install Supply Adapter
(*****48 – 60 models)

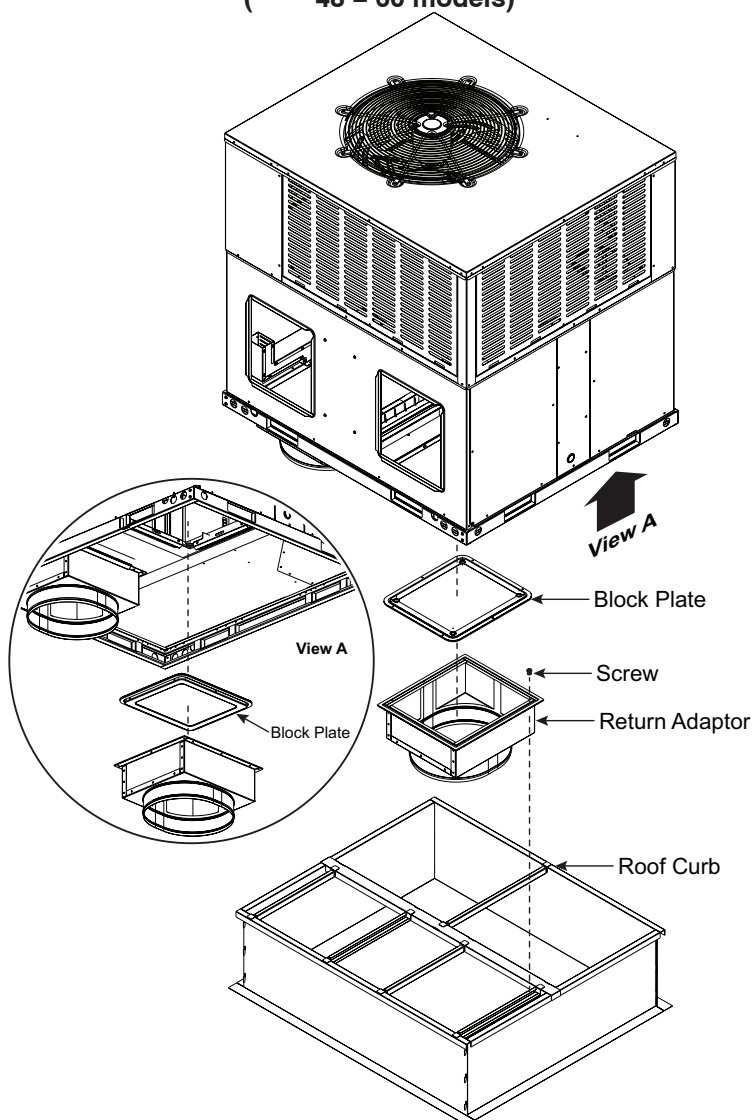
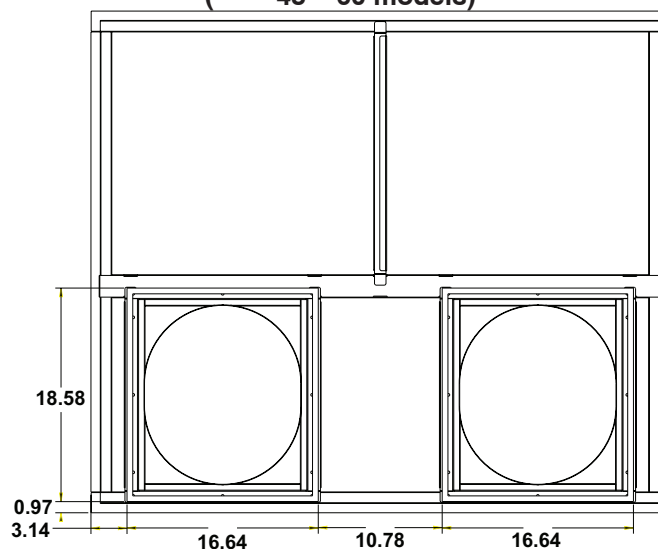
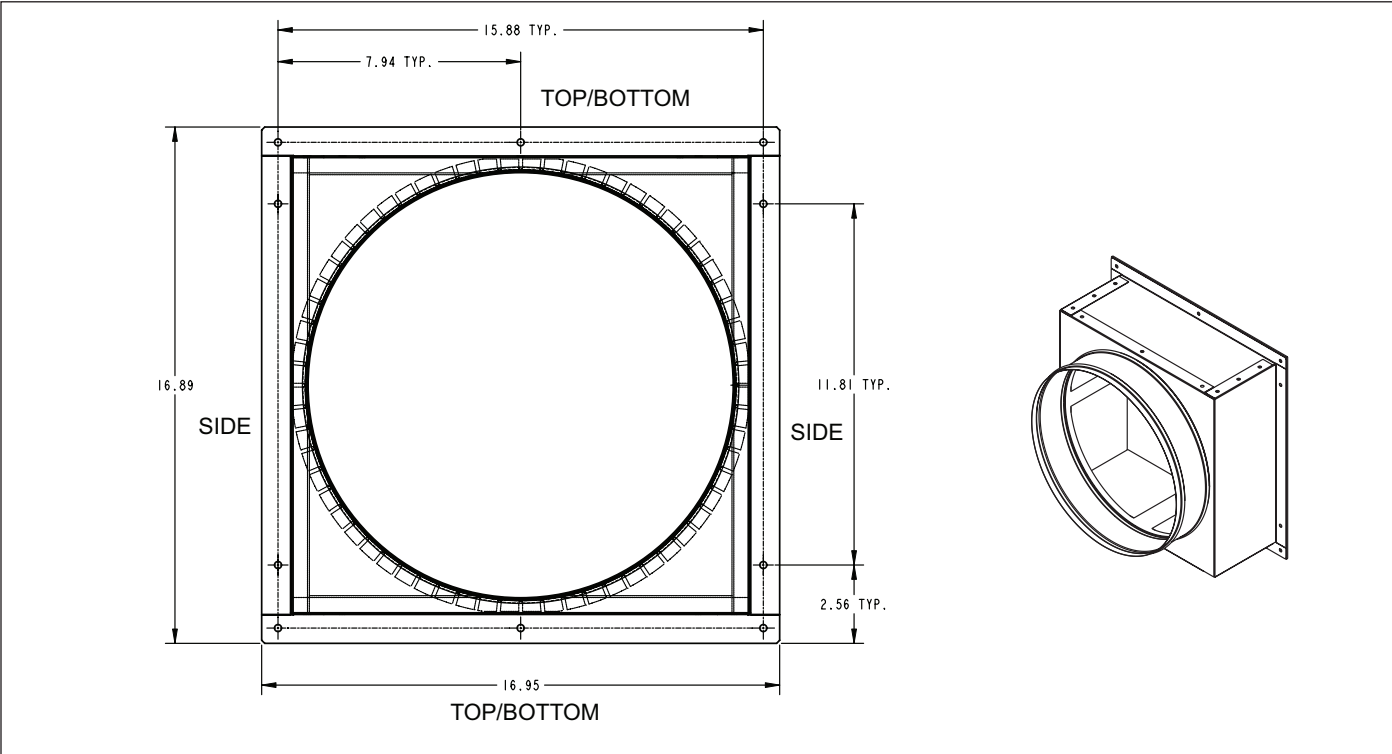

Figure 13. Install and Align Supply Adapter
(*****48 – 60 models)



Connect field supplied flex duct to the adapters and secure with field supplied clamps. See Figure 10 for dimensional drawings for flex duct sizing.

Figure 14. Dimensional Drawings
JAYSQRD001 (For use on Gas-Electric and Heat Pump Units)



JAYSQRD004 (For use on *****24 - 36 Heat Pump units)

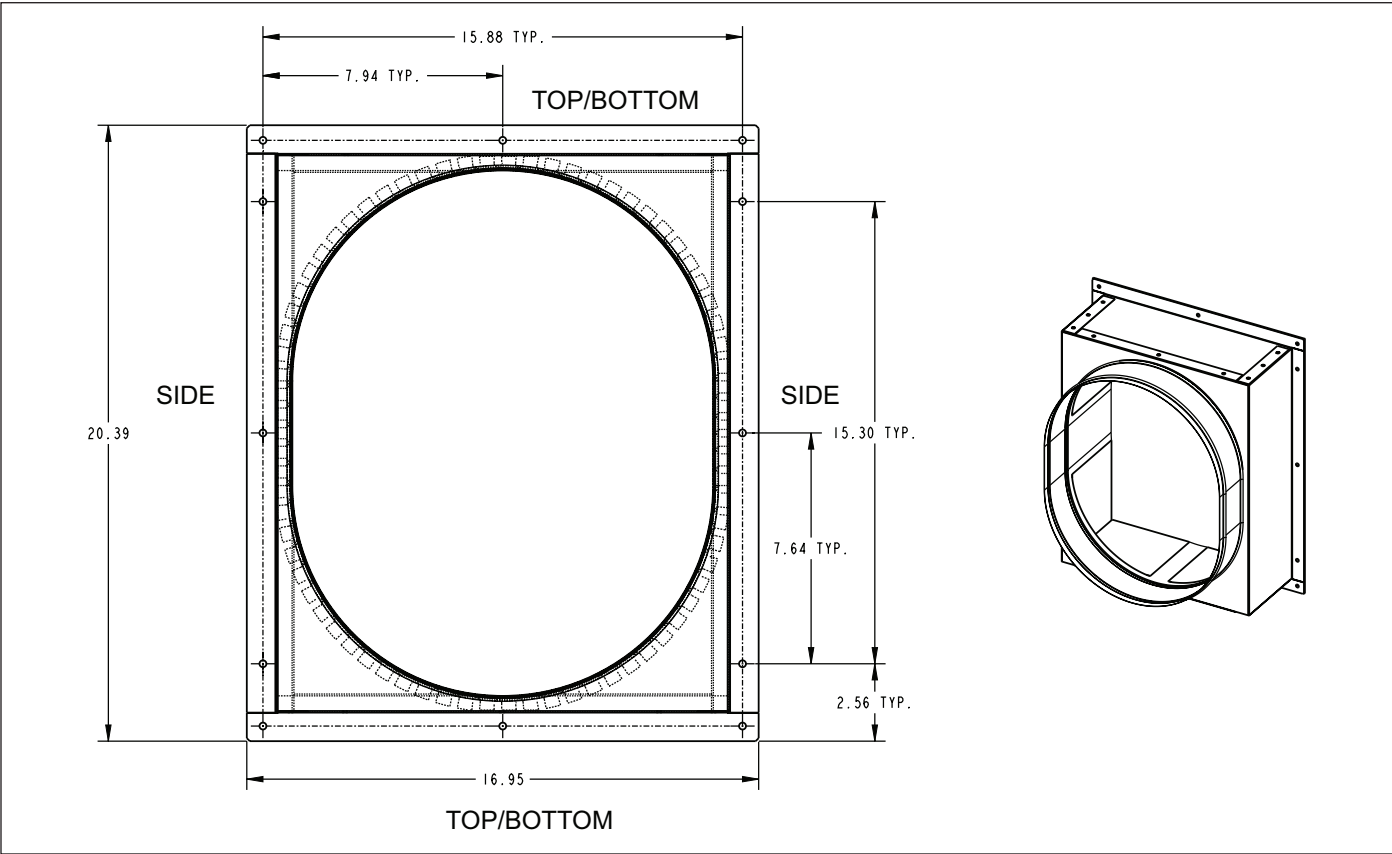

JAYSQRD005 (For use on *****42 - 60 Heat Pump units)

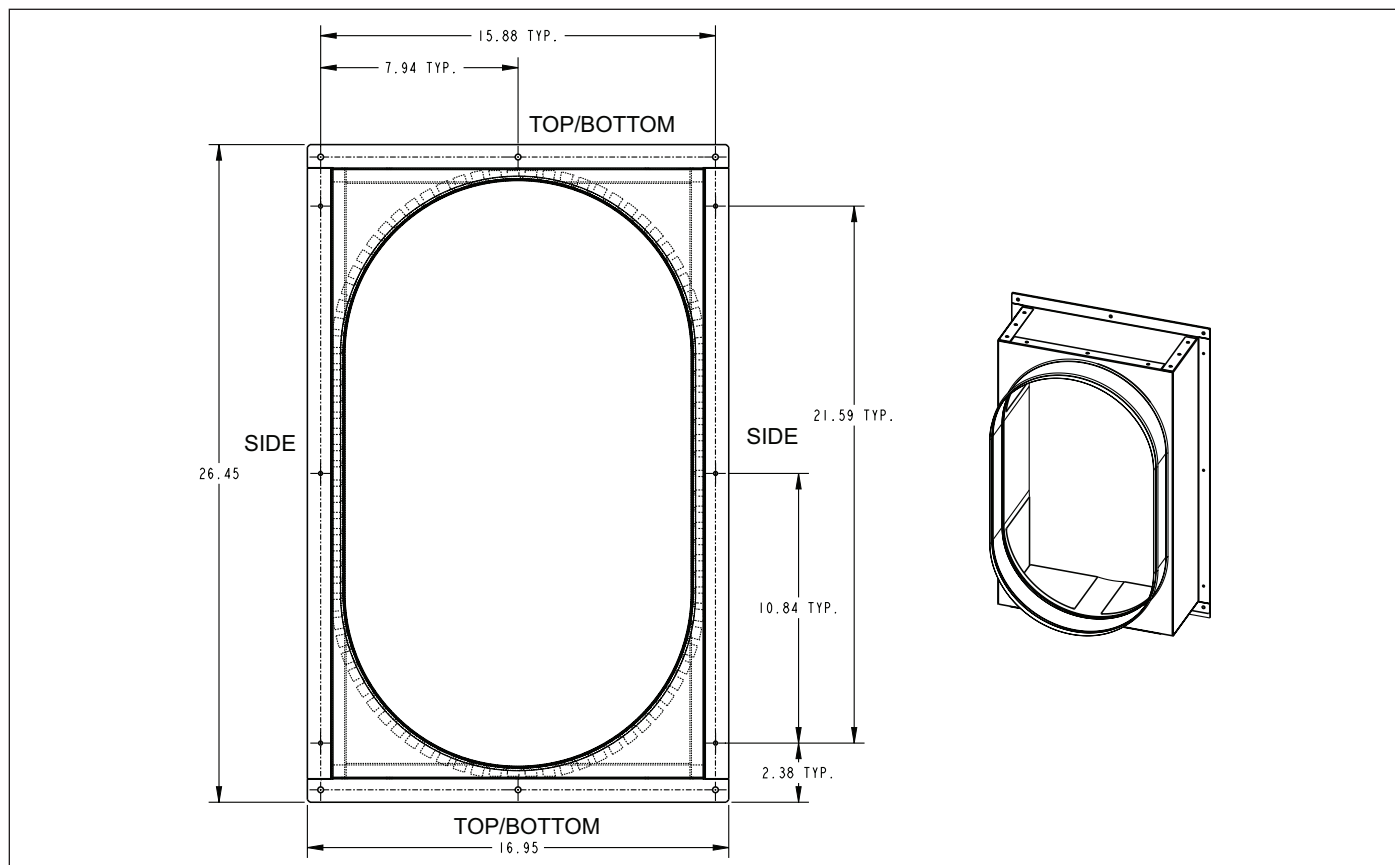

JAYSQRD002 (For use on *****24 - 42 Double Deck Gas Units)

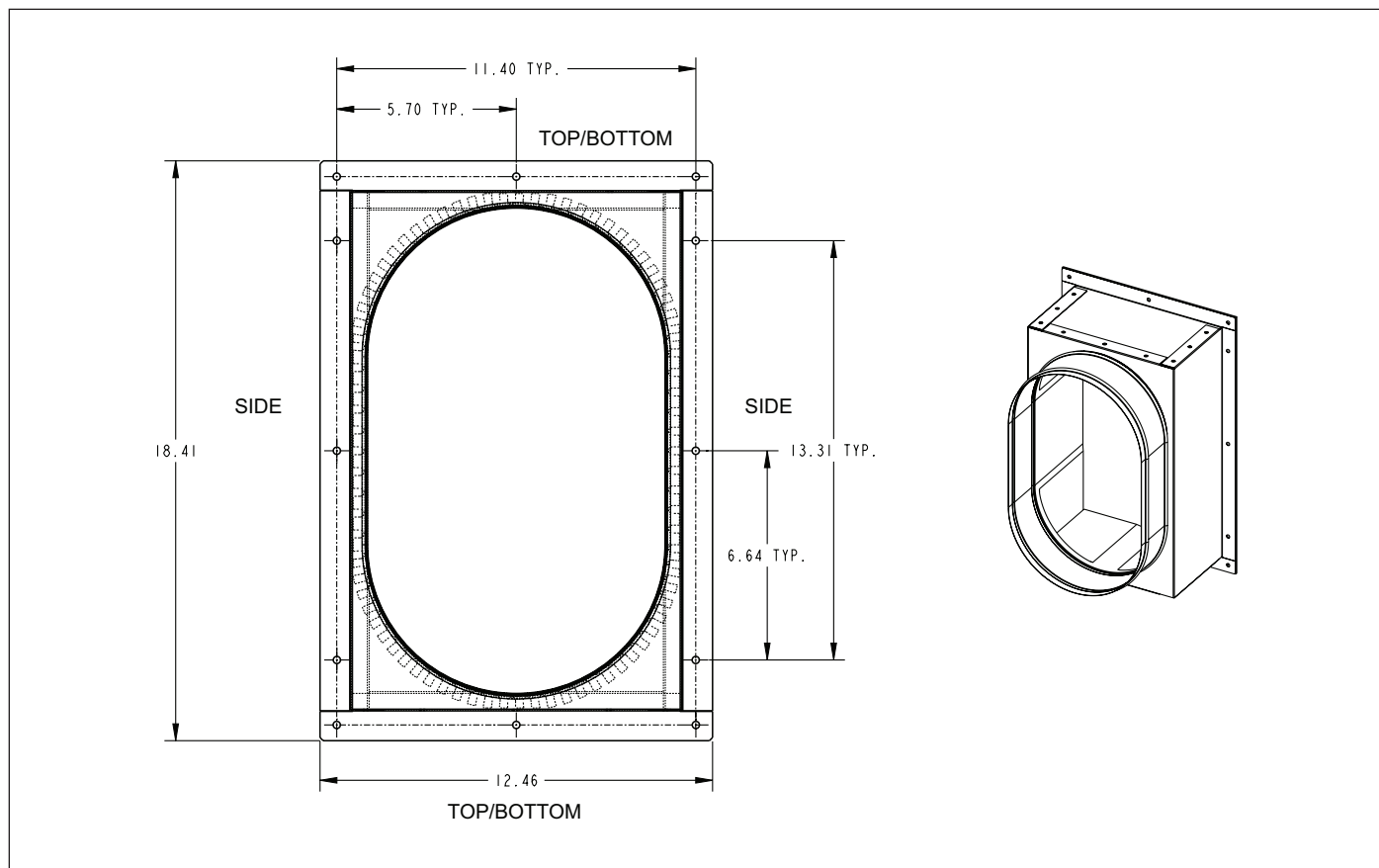

JAYSQRD003 (For use on *****48 - 60 Double Deck Gas Units)

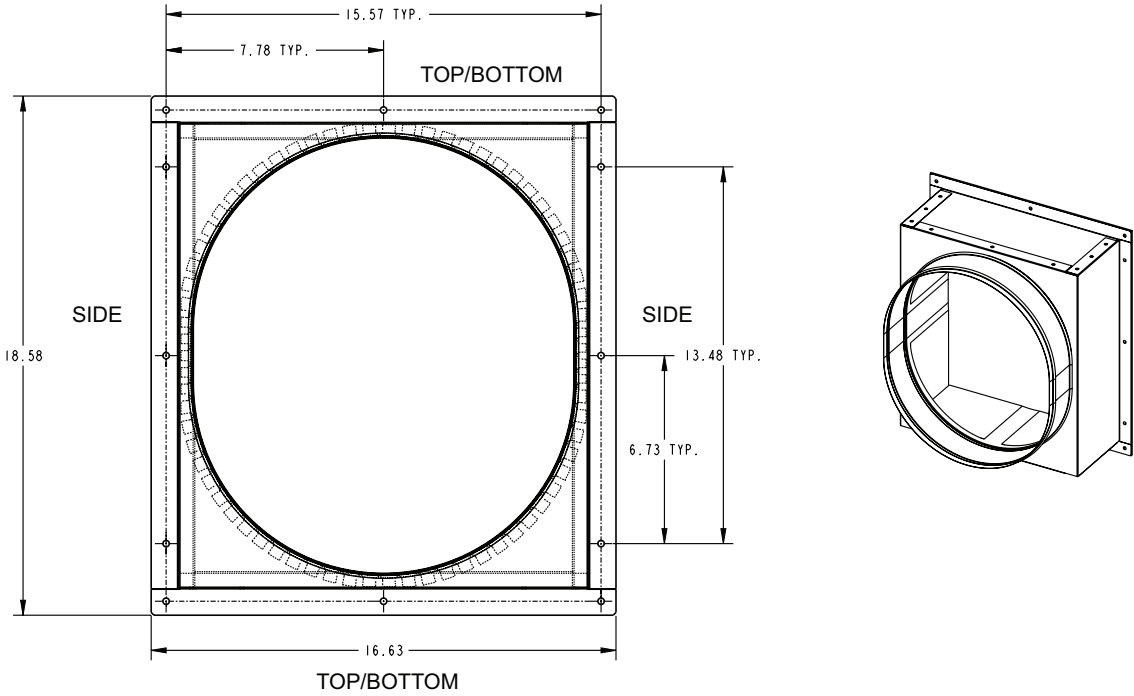

Oxbox®, endorsed by Trane®, offers simple, affordable residential heating and cooling solutions strong enough to tackle the toughest conditions. For more information visit www.oxboxhvac.com.



The manufacturer has a policy of continuous data improvement and it reserves the right to change design and specifications without notice. We are committed to using environmentally conscious print practices.

Representative-only illustrations included in this document.

BX-SVN-JAYSQRD-1B-EN 31 May 2023

Supersedes BX-SVN-JAYSQRD-1A-EN (July 2021)

© 2023